

01	carport	74.5m2	11	corridor	20 m2
02	Service area	22.4 m2	12	Office/bedroom 3	5.6 m2
03	foyer	23 m2	13	Bathroom 3	18.2 m2
04	corridor	14.5 m2	14	Powder room	1.7 m2
05	Bedroom 1	27.8 m2	15	pantry	38.2 m2
06	Bathroom 1	10.2 m2	16	Living area	33.5 m2
07	Terrace 1	6.9 m2	17	Garden	234 m2
08	Bedroom 2	27.8 m2	18	Pool	59.1 m2
09	Bathroom 2	10.2 m2			
10	Terrace 2	6.9 m2		total	634.5 m2

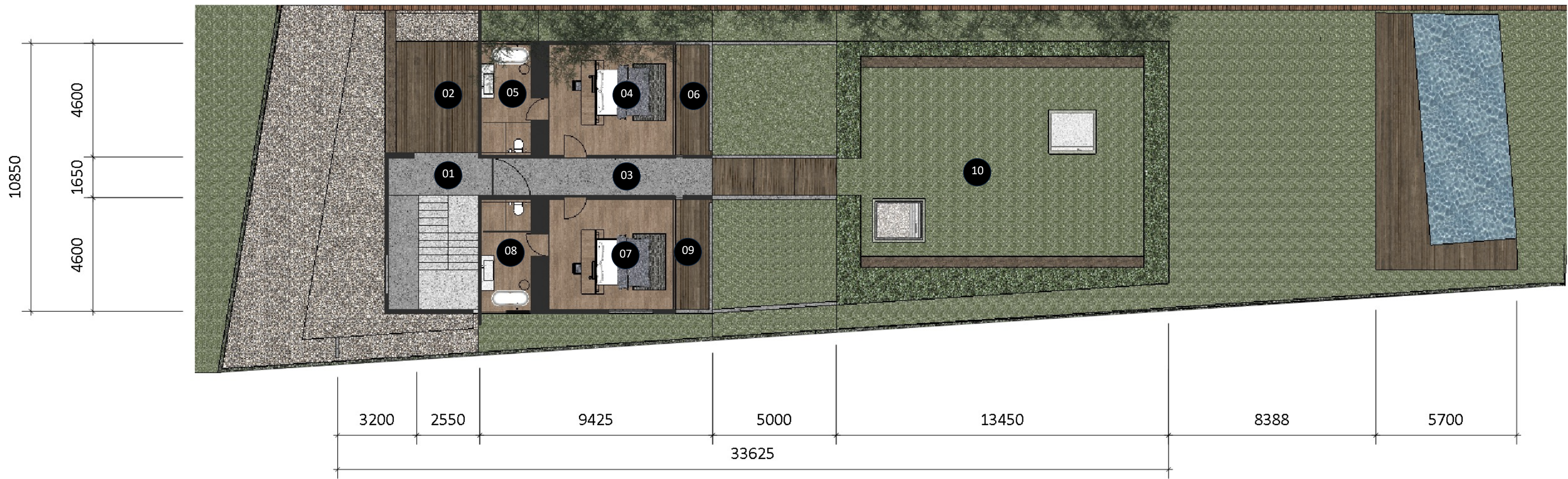

01	foyer	13.4m <sup>2</sup>
02	Outdoor terrace	16.7 m <sup>2</sup>
03	corridor	14.7 m <sup>2</sup>
04	bedroom 4	27.8 m <sup>2</sup>
05	bathroom 4	10.2 m <sup>2</sup>
06	terrace 4	6.9 m <sup>2</sup>
07	bedroom 5	27.8 m <sup>2</sup>
08	bathroom 5	10.2 m <sup>2</sup>
09	terrace 5	6.9 m <sup>2</sup>
10	rooftop	132.7 m <sup>2</sup>
	total	267.3 m <sup>2</sup>

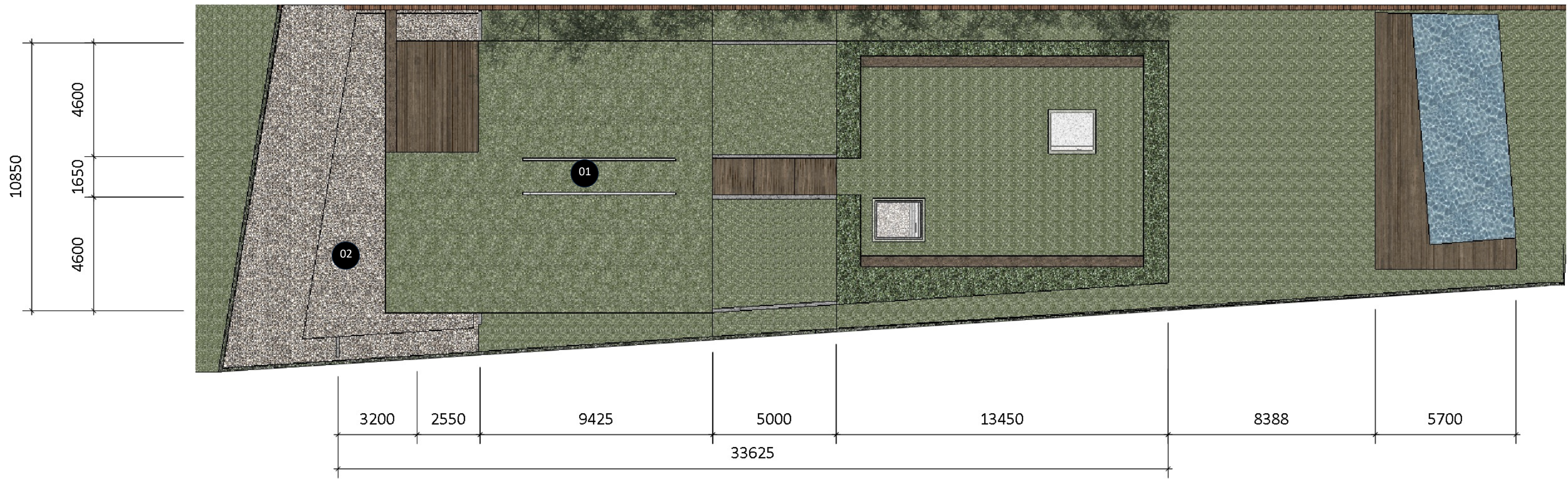

01	Rooftop 1	127.6 m2
02	Rooftop 2	36.4 m2
	total	164 m2